

# Master Plan Report appendices

Appendix A. - Larson park master plan map



- 1. GROUP PICNIC AREA W/ LARGE GRILL (RESERVABLE)
- 2. COMMUNITY GARDEN
- 3. PARK MAINTENANCE AND EQUIPMENT STORAGE
- 4. BASEBALL FIELD
- 5. RESTROOM
- 6. SMALL PICNIC AREA W/ TABLES
- 7. TENNIS COURTS (3)
- 8. PICKLE BALL COURTS (4)
- 9. BALL WALLS
- 10. BASKETBALL COURT

- 11. SMALL PICNIC AREA W/ TABLES AND SHADE STRUCTURE
- 12. SCHOOL AGE PLAY AREA, AGES 5-12
- 13. SMALL KIDS PLAY AREA, AGES 3-5
- 14. SOCCER FIELD
- 15. PATHWAY, FIRM AND STABLE AGGREGATE SURFACE
- 16. EXISTING INFORMAL TRAIL
- 17. DROP-OFF/PICK-UP ZONE
- 18. EXISTING FOOTBRIDGE TO REMAIN
- 19. EXISTING MULTI-USE BRIDGE TO REMAIN

EXISTING TREES 

PROPOSED TREES 

CREEK CENTERLINE 



# Larson Regional Park - Master Plan

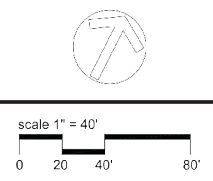

Appendix B. - table comparison existing and proposed

Larson Park - Existing and Proposed Site Facilities and Ammenities					
Recreation Facilities - Totals in Square Feet					
Item	Description	Existing	Proposed	Location	Notes
1	Ball Field	38,347	38,347	Same	Install in same general footprint as existing facility
2	Soccer Field w/ Natural Turf	65,142	66,675	Same	Install in same general footprint as existing facility
3	Fenced Courts - Tennis (3) and Pickle Ball (4)	30,278	27,955	Same	Install in same general footprint as existing facility
4	Small Picnic Area w/ Shade Structure	N/A	1,800	West of Soccer Field	and between the pickle ball courts and play area
5	Group Picnic Area w/ Grill	2,400	4,000	Same	Slightly expanded to accommodate larger groups
6	Full Court Basketball Court	3,510	3,768	Same	Install in same general footprint as existing facility
7	Play Area	3,000	6,000	Same	expanded to enhance play value and better accomodate different age groups
8	Community Garden	4,322	4,592	Same	Slightly expanded to add planting area and enhance entry access
Total		146,999	153,137		
Other Recreation Facilities					
Item	Description	Existing	Proposed	Location	Notes
9	Bike Path (Class 1) - Linear Feet	980	980	Same	Central, north/south leg shifts slightly to west. Resurface existing sections
10	Ball Wall(s)	2	2	Shift north	Move to align with fenceline of tennis court fences
Site Ammenities					
Item	Description	Existing	Proposed	Location	Notes
11	Bike Racks	N/A	10	see plan	Install in locations per master plan
12	Maintenance building - renovated	1	1	Same	Old building to be renovated in place
13	New Restroom	1	1	see plan	Centrally located near existing porta potty location, extend utilities
14	Benches	2	6	see plan	Install in locations per master plan
15	Picnic Tables	3	20	see plan	Install in locations per master plan
16	Parking Stalls (Standard 9'x18')	52	46	see plan	Parking layout (footprint) and flow patterns will be similar to existing
17	Accessible Parking Spaces	2	3	see plan	Parking layout (footprint)and flow patterns will be similar to existing
18	Footbridges	2	2	Same	Both footbridges over Pequeno creek to remain

## C. Public Participation process

### Process Overview

Sonoma County Regional Parks hosted a series of three public workshops to gather input to help guide develop a vision for an updated Master Plan for the park. The discussions and feedback at the workshops provided good insight into the issues and opportunities facing the park, and resulted in a better understanding of the current and future needs of the community relative to the park.

The first workshop was held at the La Luz meeting hall, and the second and third meetings were held in the multi-purpose room on the Flowery School campus adjacent to the Larson Park. All three meetings were conducted with English to Spanish translation service as necessary.

In addition to the public workshops, an online survey was made available through the Regional Parks' website. The survey had a limited number of participants. However, responses generally supported the discussions and feedback received during the workshops. The results are included at the end of this section.

### Public Workshop Summaries

#### **Community Workshop #1**

Sunday, September 13, 2015

2:00 – 4:00 pm

Booker Hall -La Luz,

17560 Greger St. Sonoma, CA 95476

#### **Meeting summary**

- 30 participants
- Opening remarks by Supervisor Gorin.
- Project overview by Scott Wilkinson (project manager with Sonoma County Regional Parks)
- Question and answer period
- Workshop exercise
- Report back and discussion

#### **Workshop exercise overview:**

Approximately all 30 attendees broke into small groups to discuss their ideas about the park. Groups were asked to identify a list of Assets (things they like about the park); Issues (negative aspects or things that could be improved); and Opportunities for Change (ideas for improvements including new facilities and programs). The groups discussed internally and listed their ideas for each category using provided sheets. Each group elected a spokesperson to share the highlights of their discussions and collective ideas.

The following is a summary of the ideas that were shared by the groups in each category...

ASSETS:	ISSUES:	OPPORTUNITIES:
1. Basketball	1. Gangs and drugs	1. Draw in seniors with pickle ball and bocce ball
2. Community garden	2. Safety	2. Change parking lot layout
3. Tennis	3. Speeding	3. Fencing around the park
4. Baseball	4. One access point	4. Electric fence in and out of park for police access
5. Soccer	5. Insufficient lighting	5. Dog park by creek
6. Playground	6. Garbage	6. Expand picnic areas
7. Creek	7. Safe creek access	7. Offset park uses to other park lands
8. Family picnic area	8. Functioning bathrooms	8. Wall along south side of park
9. Trees and other vegetation	9. Facility maintenance	

In addition to the group exercise and subsequent report back and discussion, comment cards were available.

**Summary of comments from the comment cards from workshop #1:**

1. The community needs more tennis courts whether we keep all four at Larson or add to Maxwell. Need a regulation soccer field. Need a baseball field somewhere. Need better lighting, benches and a working bathroom. Love the bike path.
2. What would be the cost of upgrading what we already have at Larson?
3. More shade trees, use of the (bathroom) building, steps down to the creek.
4. More patrolling surveillance. Better lighting.
5. Cleaning of the creek will attract people looking for family fun, not crime like at present.
6. More bathrooms.

## Community Workshop #2

Weds, March 2, 2016

6:30 – 8:00

Flowery School, Multi-purpose room

### Meeting summary

- 48 participants
- Workshop overview
- Presentation of three conceptual alternative plans
- Workshop exercise at table groups
- Report back and discussion

### Workshop exercise overview:

Approximately all 48 attendees broke into small groups to review and discuss their reactions to the three conceptual alternative plans that were presented. Each table group recorded their thoughts on pros and cons of each conceptual plan using provided sheets. Finally, groups were asked to choose one of the conceptual plans and discuss how they would change or refine it to better reflect their desired outcome for the park. The groups were encouraged to mark on the preferred plan and list proposed revisions and refinements on provided sheets.



The following is a summary of the collective pros and cons shared by the groups on the three conceptual alternatives...

**Conceptual Alternative #1:**



Pros	Cons
<ol style="list-style-type: none"> <li>1. Trees</li> <li>2. Soccer, baseball, tennis, etc.</li> <li>3. More green, more open space</li> <li>4. Easier to do</li> <li>5. Restrooms</li> <li>6. Free access</li> <li>7. Family friendly</li> <li>8. This is the best one, add 1 more court</li> <li>9. Develop areas over by garden and behind the tennis courts for sitting</li> <li>10. Restroom change</li> <li>11. Proper soccer field</li> <li>12. Restrooms in middle</li> <li>13. Tree barrier along south fence</li> <li>14. Keeping baseball field</li> <li>15. Keep four tennis courts intact. 3 used for tennis, 1 used for pickle ball</li> <li>16. Pickle ball court</li> <li>17. Separate fields, soccer and baseball</li> <li>18. No ugly shade structures</li> <li>19. Lower expense</li> <li>20. Larger soccer field</li> </ol>	<ol style="list-style-type: none"> <li>1. Get racquetball out</li> <li>2. Basketball in and just keep it</li> <li>3. Better baseball fence</li> <li>4. Don't remove tennis courts please, pickleball lines on one court</li> <li>5. Higher fencing</li> <li>6. Remove basketball courts. No bike/trike area</li> <li>7. Removing 2 tennis courts</li> <li>8. Improve baseball field</li> <li>9. Lights</li> <li>10. No barrier between picnic area and parking lot</li> <li>11. No need for regulation soccer field</li> <li>12. No basketball court</li> <li>13. Reduced tennis</li> <li>14. No wall ball / back walls</li> <li>15. No creek access</li> <li>16. Only 2 tennis courts</li> <li>17. No basketball</li> <li>18. Need another 2 or 3 picnic tables</li> <li>19. Need another tennis court</li> <li>20. Need turn around for parking</li> </ol>

## Conceptual Alternative #2:

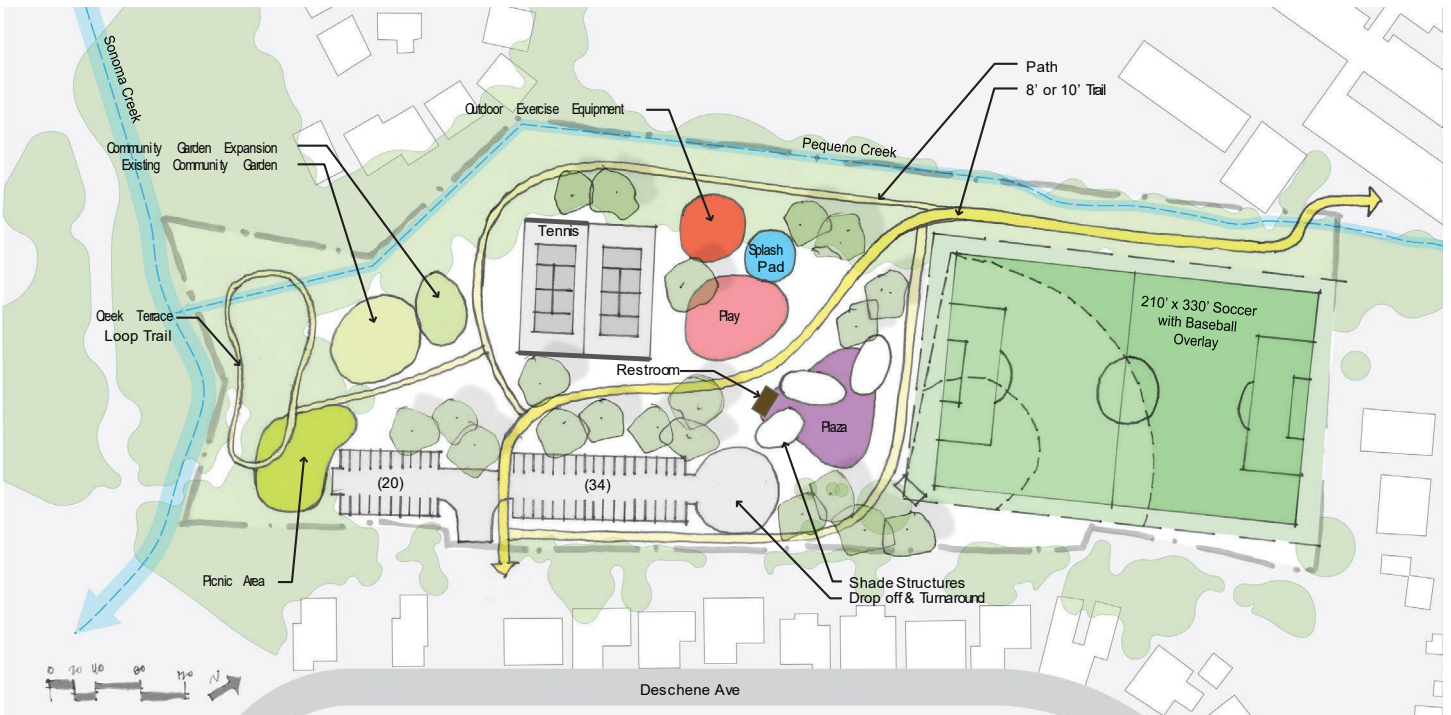

Pros	Cons
<ol style="list-style-type: none"> <li>1. Like overlap of baseball and soccer field</li> <li>2. Parking layout</li> <li>3. Restroom</li> <li>4. Plaza area</li> <li>5. Turn around</li> <li>6. Community garden</li> <li>7. Larger field</li> </ol>	<ol style="list-style-type: none"> <li>1. Others do not want overlap of fields</li> <li>2. Reducing 2 tennis courts</li> <li>3. Creek terrace loop</li> <li>4. Parking turn around</li> <li>5. Lights</li> <li>6. Splash pad</li> <li>7. No creek access</li> <li>8. No basketball</li> <li>9. Outdoor exercise equipment</li> <li>10. No dedicated baseball</li> <li>11. No drain needed</li> </ol>



### Conceptual Alternative #3:



Pros	Cons
<ol style="list-style-type: none"> <li>1. Restroom location</li> <li>2. Community garden</li> <li>3. Larger field</li> <li>4. Save space with field combination</li> </ol>	<ol style="list-style-type: none"> <li>1. Baseball and soccer on same field</li> <li>2. Just bad, remove tennis, basketball, baseball field and put in open area???</li> <li>3. Open lawn no good in drought</li> <li>4. Need 4 tennis courts</li> <li>5. Basketball removal</li> <li>6. Less parking</li> <li>7. Lights</li> <li>8. Open lawn / event stage</li> <li>9. No creek access</li> <li>10. No wall ball</li> <li>11. Open lawn cost</li> </ol>

### **Preferred Alternative Comments and Suggestions:**

1. Keep it the same. Create more sitting near gardens and back of courts
2. Keep 4 tennis courts
3. Keep basketball
4. Keep wall ball
5. Keep soccer and baseball fields separate
6. Lighting
7. Restrooms need to be added
8. Playground for older children
9. Create path around, not through the park
10. Keep community garden
11. Larger field
12. Artificial turf
13. Overlay fields is okay
14. Central restrooms
15. More picnic tables
16. Larger parking and turn around
17. Shade trees
18. More trash containers
19. No stage
20. No pool

### **Additional Comments by Group:**

#### **Group 1-**

- the tennis courts should be preserved
- do not overlap the soccer and baseball fields
- create more family open spaces

#### **Group 2-**

- enhance what is already there
- keep all four tennis courts and basketball court

### **Group 3-**

- keep the park as is
- more lights and a new paint job
- improve creek access
- keep all existing fields and activities
- create playground equipment for older kids
- remove any features that invite the homeless or make it comfortable for them to stay
- add bathrooms

### **Group 4-**

- keep all four tennis courts and light them
- move playgrounds by community garden
- keep all existing sport fields

### **Group 5-**

- keep all existing activities
- develop the north/west corner with playground to get rid of the homeless and drug users
- create restrooms in the middle
- like the parking turn around loop

### **Group 6-**

- just fix what is there
- move bathroom
- improve creek access
- create a route for police patrol

### **Group 7-**

- soccer field is the most important
- artificial turf is a good idea
- create 3 to 4 tennis courts with pickle ball
- more picnic tables
- add safety lighting

### **Final Observation:**

The most common thread of the evening was to keep everything that was already there and just improve and upgrade the facilities. While the process of creating a Master Plan presents the opportunity to re-envision the features of park, the representation at the meeting was not inclined towards change. It is clear that removing any of the existing sports activities will be met with strong opposition.

## Summary of comments from the comment cards from workshop #2:

1. Karla - My comment is that to keep the basketball court because there's no other park just like the basketball court. Just keep the basketball court. I know people and my family that goes there and plays basketball to practice for teams or to have fun. Just keep it!
2. Nancy Swick - How can the current layout just be buffed up? Is there a way to have community help with being stewards for the park – to keep it clean and tidy? How can we help? How can it be accessed easier by pedestrians? Would love to see the park more bike and ..... friendly. Possible to enhance flood control, seasonal pond, swales, something?
3. Serena - None of the plans really work (sorry). Keep the park like it is. Add pickle ball lines on one of the courts with portable nets. Bathrooms need to be out in the open. Very dangerous now. Walls are great need to keep something like what is there. Keep basketball. Improve baseball field and soccer field. Jungle gym for older kids. All the sitting area will bring in a bad crowd. Develop the area near the garden and creek for open space. Lighting for safety.
4. George McKale - No changes whatsoever. I love the look, just upgrade everything. Keep all four tennis courts. Have been using Larson for 20 years. Tennis and little league.
5. Mark - The dual use of the soccer field and baseball allows for greater diversity of use and will attract more people, increase safety and allow beautification with more trees (both Alt 2 and 3). Alt. 2 may be more conducive to families picnicking next to game fields. Alt. 3 has more open space and eliminates com garden expansion, which should not be next to the creek due to nutrient loading. Creek terrace should not be developed and left open for restoration and informal use by park visitors. Maintain all setbacks from creeks, including Pequeno. No more pavement or formal pathways in setbacks.
6. Bastian Schoell - While I love the creativity of Alt 2 & 3, the financial realities and the need for a working / functional community resource in this location make me favor Alt 1, which maintains the current layout and minimizes major earth movement. Alt 1 maintains the spirit of functionality with the highest chance of success. 3 Tennis courts should be possible through tightened layout.
7. Suzanne Ring - Too much traffic for increase soccer on Dechene. No artificial turf, environmental impact near creek, odor, mess, black rubber balls everywhere is unhealthy. Will fall apart and too expensive to fix, will be giant mess. Access through Flowery, too much traffic on DeChene, spreading. What about soccer at Flowery? Keep like it is, just fix it up. It is beautiful. Keep it natural.
8. I think it should basically be improved upon upgraded. Add better playground and restrooms and lighting. No artificial turf. Better fencing near homes / soccer area. Better access from Flowery. Safety patrolling. Baseball field used on off season other ways.
9. Patty Bongiovanni - I live on the park Dechene Ave. The things that are used daily: basketball daily. Baseball for little league practice during season daily. Soccer field (on Sundays only). Tennis (not that much but courts are poor). Tennis backstop is used every afternoon as a soccer wall ball court. The creek on warm days.
10. Samantha Chapin - Used daily: basketball, tennis, backboards, baseball. Please do not take away these things. Soccer on Sunday only. If Maxwell Park will soon have a regulation size soccer field, why are we giving up tennis and basketball when we can just fix up the current field and keep everything we have? We need to keep separate baseball field because of Pauls field closing.
11. Diane Barker – To hold tennis tournaments / little league matches, a minimum of four tennis courts is required. We do need to recognize pickleball. What about keep 4 courts at Larson and putt pickleball at Maxwell? We need to recognize the location of Larson Park within the community. We need to address the needs of families better.
12. Mike Giangrew – Utilize one tennis court space for 4 pickleball courts or stripe the tennis courts for pickleball.

13. Bruce Lamoreaux – Idea, love the large tennis area but courts could be closer together resulting in 3 tennis courts and use the 4th court area for pickleball. If you designate 1 tennis court to pickleball then you get 4 pickleball courts. (16 people on 4 pickleball courts = 1 tennis court) 3 tennis courts are enough for a tournament results in locals and outsiders coming for tournament bring money to Sonoma. Need ball walls, open lawns, waste water and maintenance.
14. Michelle Skipwith – Please keep all 4 courts at Larson Park! Many of the tennis players live on this side of town and history indicates this is a favored park. Additionally, this “sweet spot” will bring new players (youth and adults) and program development is being planned to expand into the community. For an area as small as Sonoma / Springs is this is one of the largest and most active areas of tennis in the North Bay. Youth tennis, leagues, tournaments, social play will all benefit this community. If you need statistical information, I can help provide to show growth that we need to keep 4 courts at Larson and add 2 proposed at Maxwell Park.
15. Basat, Rose, Lyne, Richard, Anna – None of the alternatives are realistic and serves well. Keep simple and economical. Current soccer field is 330 ft. long good enough! Keep 4 tennis courts. Keep it simple / spend money to upgrade the facility and save money for regular and proper maintenance.
16. Ana Flaherty – The “kiss” theory should be put in effect. Keep It Simple Stupid. The basketball court should stay. Tennis courts closer together to keep all 4. Baseball field and soccer stay. Garden stays.
17. Richard Flaherty – Very strongly believe that tennis should be shown greater priority. We strongly need more tennis courts in this vicinity. Tennis will bring in more money as more visitors come and play tennis. We do not benefit from fewer courts. We do not benefit from “splash ponds” etc. We can turn Larson Park into an athletic complex.
18. Luis Contreras – I think the park layout should stay the way it is. The thing is, instead of wasting budget on building new things, you should use the budget to have some maintenance on the park to fix things that are worn out. Basically, it would be best to renew the things that we have in that park and I feel the park would be a better attraction that way.
19. A well-lighted park that is well-maintained with trees, playground and fields that attract people.
20. Sensor lights to avoid disturbing residents (rather than lights that are on all night). Please use solar powered lights.
21. Alejandra Cervantes - I like how the park is structured so far. I like the balance and division of the parking lot and the natural form of the trees and the river. I like that the park is free and thus accessible for all families and their pets. I would like residents of Agua Caliente and Spring Village to be able to access the park along the river (and across the river). It would be great to use community talent to create art and sculpture that represent the beauty and richness of the Springs community.

## Community Workshop #3

Wednesday, August 23, 2017 6:30 – 8:00 pm

Flowery School, Multi-purpose Room

### Meeting summary

- 26 participants
- Workshop overview
- Presentation of draft Master Plan
- Workshop exercise at table groups
- Group report back and discussion

### Workshop exercise overview:

Approximately all 26 attendees broke into groups to review and discuss the proposed draft Master Plan. Each table group recorded their thoughts on what they liked, and what they disliked about the plan, and also shared their ideas for improving it. The groups were encouraged to mark on the draft plan and list their comments on provided sheets for sharing with the larger group during the report back portion of the workshop.

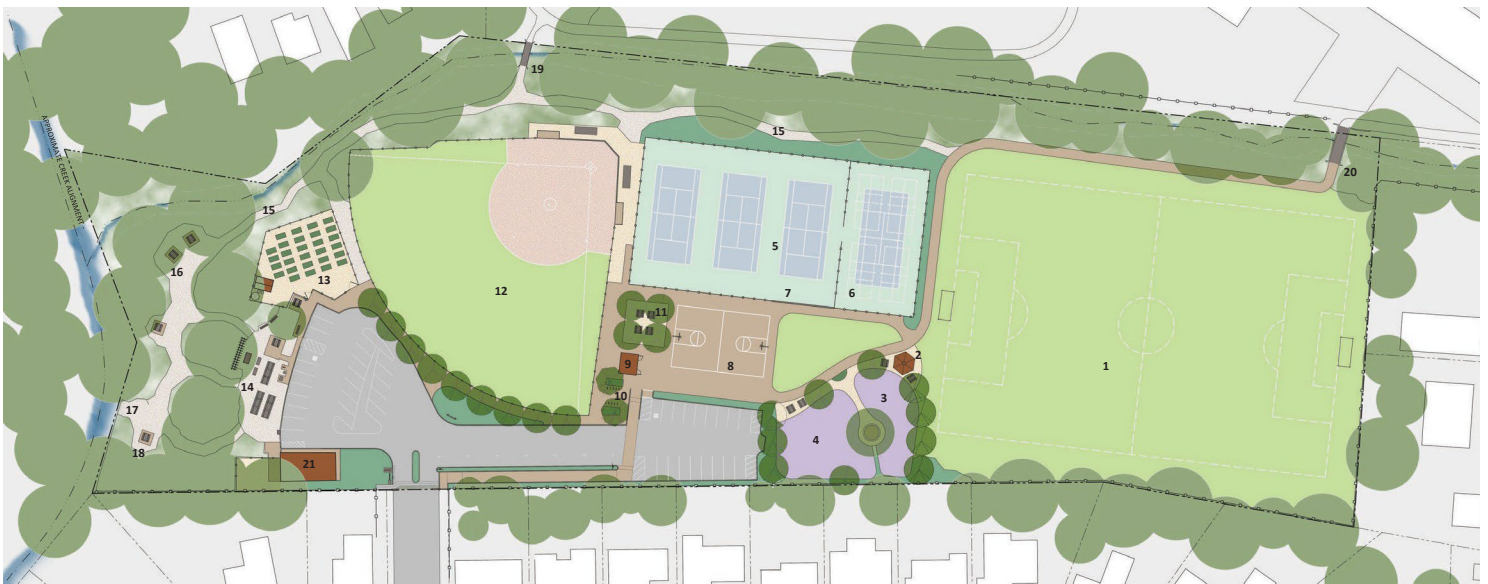

- 1 SOCCER FIELD - RENOVATED W/ NATURAL TURF / CAMPO DE FUTBOL – RENOVADO CON TURF NATURAL
- 2 COVERED PICNIC STRUCTURE / ESTRUCTURA CUBIERTA PARA PICNICS
- 3 SMALL KIDS PLAY AREA, 3-5 / ÁREA DE JUEGO PARA NIÑOS PEQUEÑOS, 3-5
- 4 SCHOOL AGE PLAY AREA, 5-12 / ÁREA DE JUEGO PARA NIÑOS QUE VAN A LA ESCUELA, 5-12
- 5 TENNIS COURTS, 4 RE-BUILT / CANCHAS DE TENIS, 4 RE-CONSTRUIDO
- 6 PICKLE BALL OVERLAYS, 4 COURTS / 4 CANCHAS DE PICKLE BALL CON LINEAS
- 7 BALL WALL / PARED DE BOLAS
- 8 FULL SIZE BASKETBALL COURT / CORTE DE BALONCESTO DE TAMAÑO COMPLETO
- 9 RESTROOM / SERVICIOS HIGIENICOS
- 10 BIKE RACKS / BASTIDORES PARA BICICLETAS
- 11 PICNIC TABLES / MESAS DE PICNIC

- 12 BASEBALL FIELD - RENOVATED W/ NATURAL TURF / CAMPO DE BÉISBOL – RENOVADO CON TURF NATURAL
- 13 COMMUNITY GARDEN W/ ENTRY EXPANSION / JARDÍN COMUNITARIO CON LA ENTRADA EXPANDIDA
- 14 GROUP PICNIC AREA W/ GRILL / ÁREA DE PICNICS CON PARILLA PARA GRUPOS
- 15 INFORMAL TRAIL LOOP / SENDERO CIRCULAR INFORMAL
- 16 PICNIC TABLES / MESAS DE PICNIC
- 17 STABILIZED CREEK ACCESS / ACCESO ESTABILIZADO AL RIACHUELO
- 18 INFORMAL CREEK OVERLOOK / VISTA AL RIACHUELO
- 19 EXISTING BRIDGE TO REMAIN / PUENTE EXISTENTE SE PERMANECE
- 20 NEW BRIDGE AND PATHWAY / NUEVO PUENTE Y CAMINO
- 21 PARK MAINTENANCE & EQUIPMENT STORAGE / ALMACENAMIENTO DE EQUIPO PARA MANTENER EL PARQUE

DRAFT MASTER PLAN

As presented at Workshop #3



## Comments on draft Master Plan by Group:

### Group 1-

---

#### *What did you like about the plan?*

- We like it all – appreciate all the thought and consideration that went into it.

#### *What do you dislike about the plan, and what ideas do you have for improving it?*

- Artificial turf
- Bleachers for the soccer field
- Some kind of sign telling the story of the park

### Group 2-

---

#### *What did you like about the plan?*

- Covered picnic structure is a great idea, but it needs to be bigger
- Improved walkway is fantastic
- Fact that existing layout is being reused is a great idea –reduces overall costs

#### *What do you dislike about the plan, and what ideas do you have for improving it?*

- Please evaluate costs for artificial turf vs. natural turf. Consider upfront vs. long term
- More trees to screen the play area from houses
- More shade for informal turf/ball wall area
- Restrooms – please study Sunday morning usage during soccer. Currently, soccer players and families urinate in the trees on south side of soccer pitch. Two stalls are not enough for Sunday ams
- Keep art mural > move it

### Group 3 - N/A

---

### Group 4-

---

#### *What did you like about the plan?*

- Overall design is very nice.
- New reconstructed tennis courts.
- Fact that existing layout is being reused is a great idea –reduces overall costs

#### *What do you dislike about the plan, and what ideas do you have for improving it?*

- Limited parking – can't afford to lose parking spaces
- Tennis wall needs paved area (and is better outside of court area so it can be used while people are using the courts). Grass doesn't work
- Keep four dedicated tennis courts

- Move pickle ball to a separate area
- Need a high net at the end of soccer field to keep soccer balls from going into tennis courts.
- Security lighting

#### **Group 5-**

---

##### ***What did you like about the plan?***

- That its going to be improved upon
- New reconstructed tennis courts
- Fact that existing layout is being reused is a great idea –reduces overall costs
- Two bridges are good.

##### ***What do you dislike about the plan, and what ideas do you have for improving it?***

- More money should be spent on Larson and less on Andy Lopez Park
- Soccer field is way too big, and will bring more traffic down Dechene Ave.
- Older bridge on West end of Pequeno Creek should be bigger for strollers and bikes

#### **Group 6-**

---

##### ***What did you like about the plan?***

- Informal triangle of turf area is good
- Permanent restroom (high priority)

##### ***What do you dislike about the plan, and what ideas do you have for improving it?***

- A second access point is needed
- Lighting
- Better signage

#### **Group 7-**

---

##### ***What did you like about the plan?***

- Thank you for listening and keeping what's there already
- Picnic tables and benches
- Playground

##### ***What do you dislike about the plan, and what ideas do you have for improving it?***

- More shade for picnic tables and benches
- More seating options adjacent heavy use areas such as play areas and tennis courts
- Removable benches down by creek for winter flooding
- Better equipment storage



## **Group 8**

---

### ***What did you like about the plan?***

- We like overall design including creek access and community garden expansion
- No lighting

### ***What do you dislike about the plan, and what ideas do you have for improving it?***

- More bike racks
- More trees in the central area near the informal turf triangle –more shade

### **Summary of comments from the comment cards from Workshop #3:**

1. Who will use the renovated soccer fields: Adult/kids league?
2. Provide more shade and seating for parents adjacent to play area
3. Provide seating for viewers of tennis courts
4. Provide adequately sized restrooms
5. Disperse bike racks around the park not only in one location
6. Trees at outfield fence could be better placed elsewhere for shade value
7. Please keep ball walls they are needed
8. Improve creek area trails, and add seating

# Online Survey Results

## Q1 Where do you live?

Answered: 13 Skipped: 0

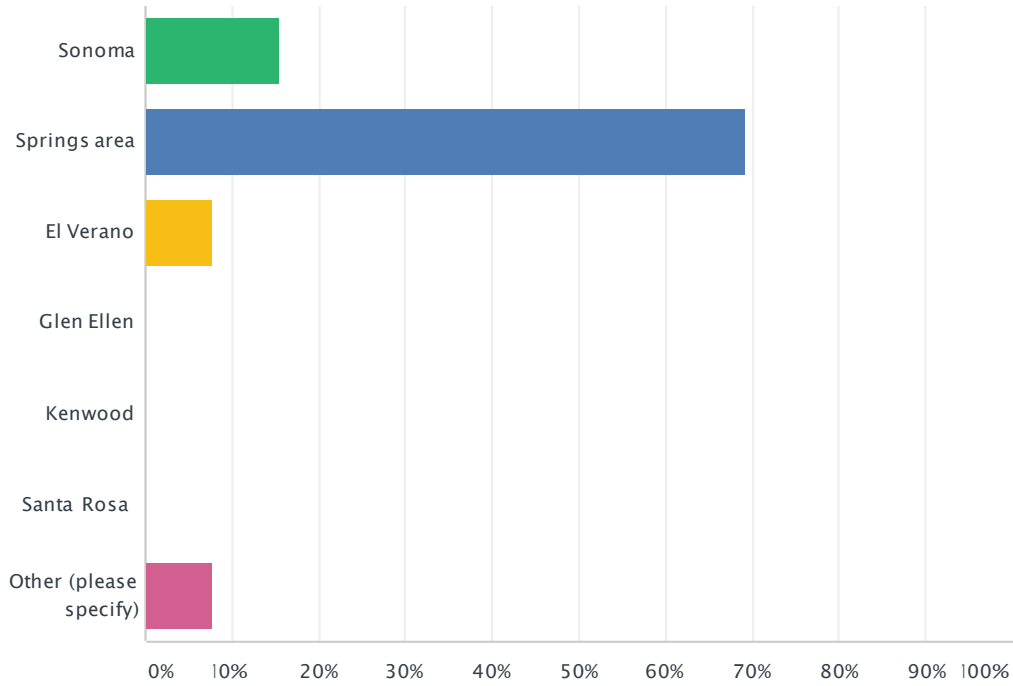

ANSWER CHOICES	RESPONSES
Sonoma	15.38% 2
Springs area	69.23% 9
El Verano	7.69% 1
Glen Ellen	0.00% 0
Kenwood	0.00% 0
Santa Rosa	0.00% 0
Other (please specify)	7.69% 1
<b>TOTAL</b>	<b>13</b>

#	OTHER (PLEASE SPECIFY)	DATE
1	Sonoma County, near SR Fairgrounds	9/13/2015 9:11 AM

## Q2 What is your age?

Answered: 13 Skipped: 0

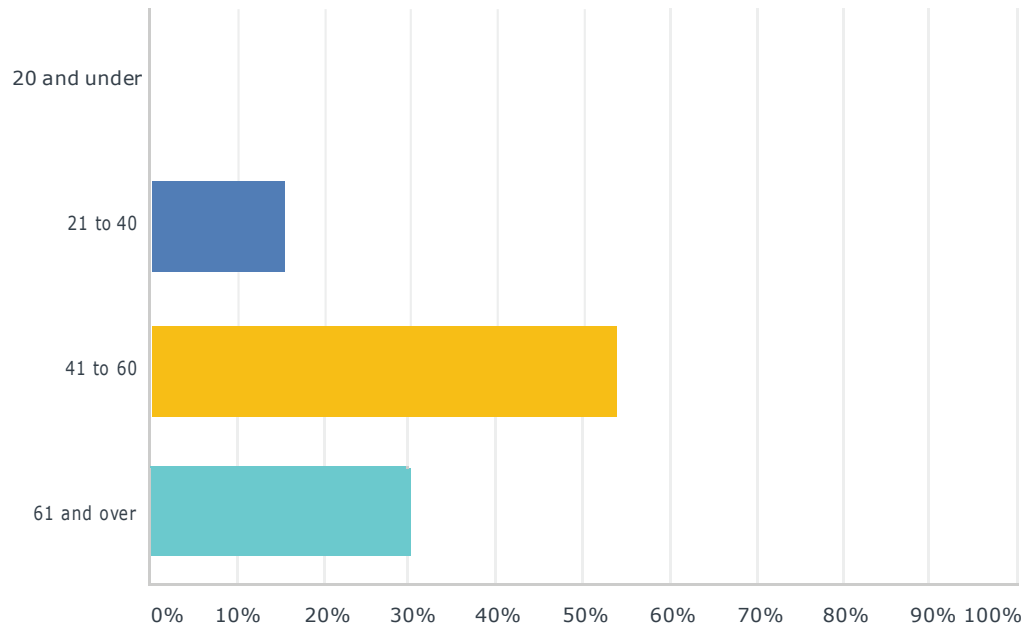

ANSWER CHOICES	RESPONSES	
20 and under	0.00%	0
21 to 40	15.38%	2
41 to 60	53.85%	7
61 and over	30.77%	4
TOTAL		13

### Q3 How often do you visit Larson Park?

Answered: 13 Skipped: 0

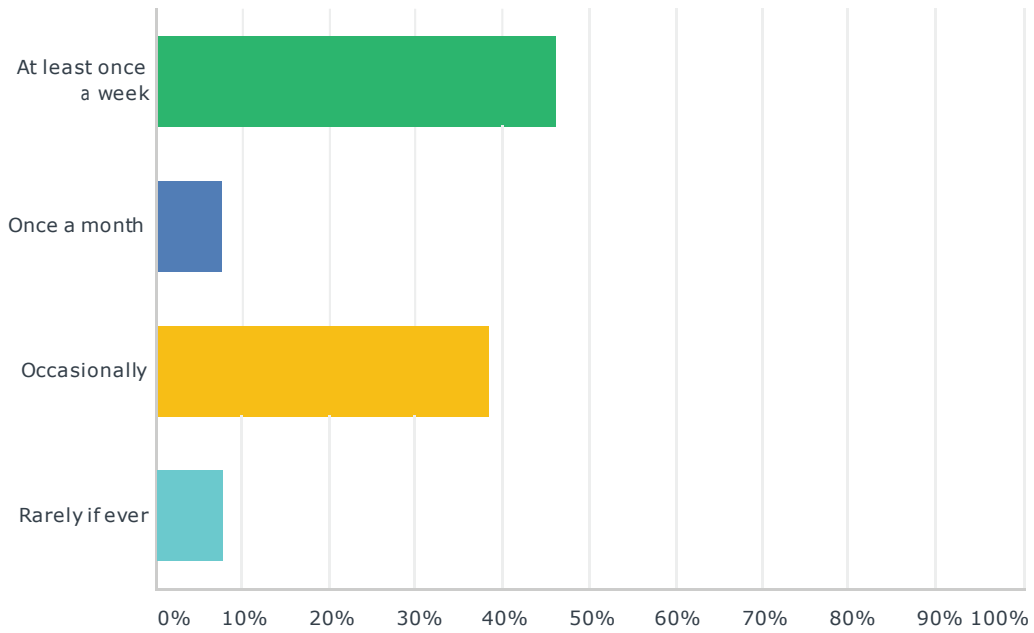

ANSWER CHOICES	RESPONSES	
At least once a week	46.15%	6
Once a month	7.69%	1
Occasionally	38.46%	5
Rarely if ever	7.69%	1
<b>TOTAL</b>		<b>13</b>

# Q4 Who do you typically go to the park with? (choose all that apply)

Answered: 13 Skipped: 0

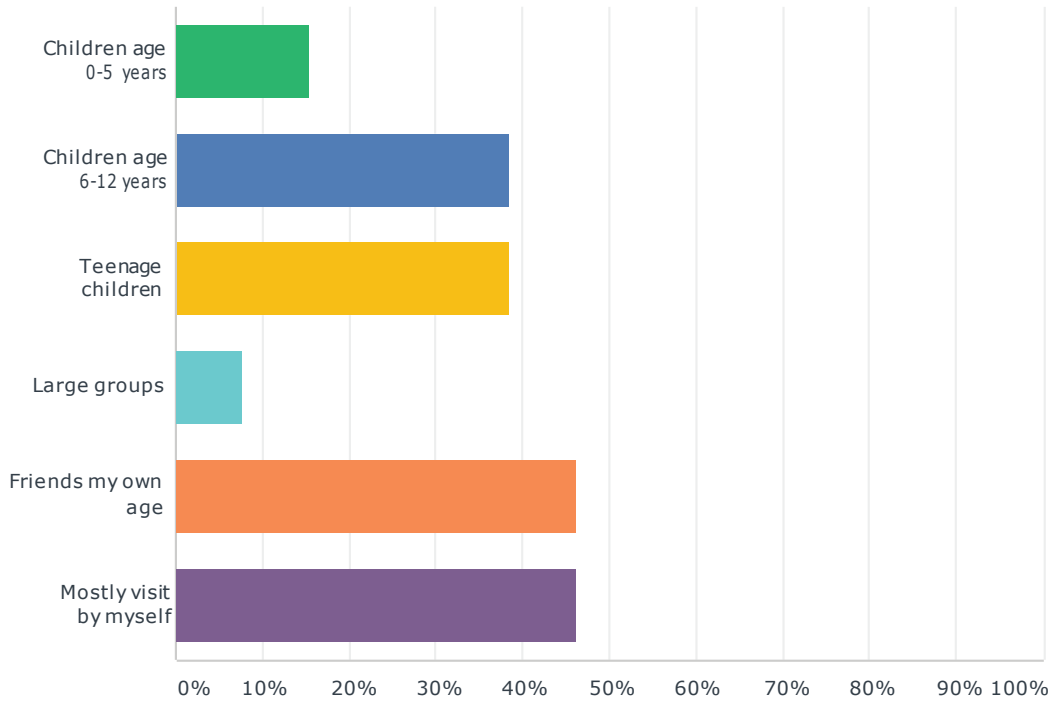

ANSWER CHOICES	RESPONSES	
Children age 0-5 years	15.38%	2
Children age 6-12 years	38.46%	5
Teenage children	38.46%	5
Large groups	7.69%	1
Friends my own age	46.15%	6
Mostly visit by myself	46.15%	6
Total Respondents: 13		

## Q5 How do you typically get to the park?

Answered: 13 Skipped: 0

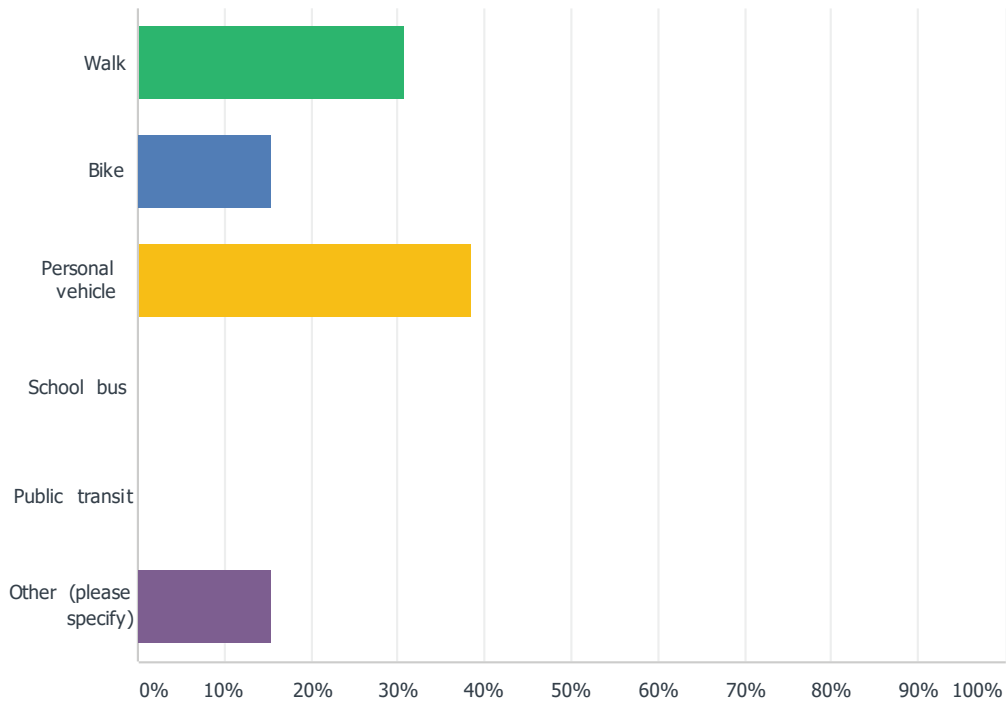

ANSWER CHOICES	RESPONSES	
Walk	30.77%	4
Bike	15.38%	2
Personal vehicle	38.46%	5
School bus	0.00%	0
Public transit	0.00%	0
Other (please specify)	15.38%	2
<b>TOTAL</b>		<b>13</b>

#	OTHER (PLEASE SPECIFY)	DATE
1	Out my gate that opens onto the park	9/9/2015 10:00 PM
2	Walk through my private back gate into the park	9/9/2015 4:59 PM

## Q6 Why do you visit the park? (choose your top three)

Answered: 13 Skipped: 0

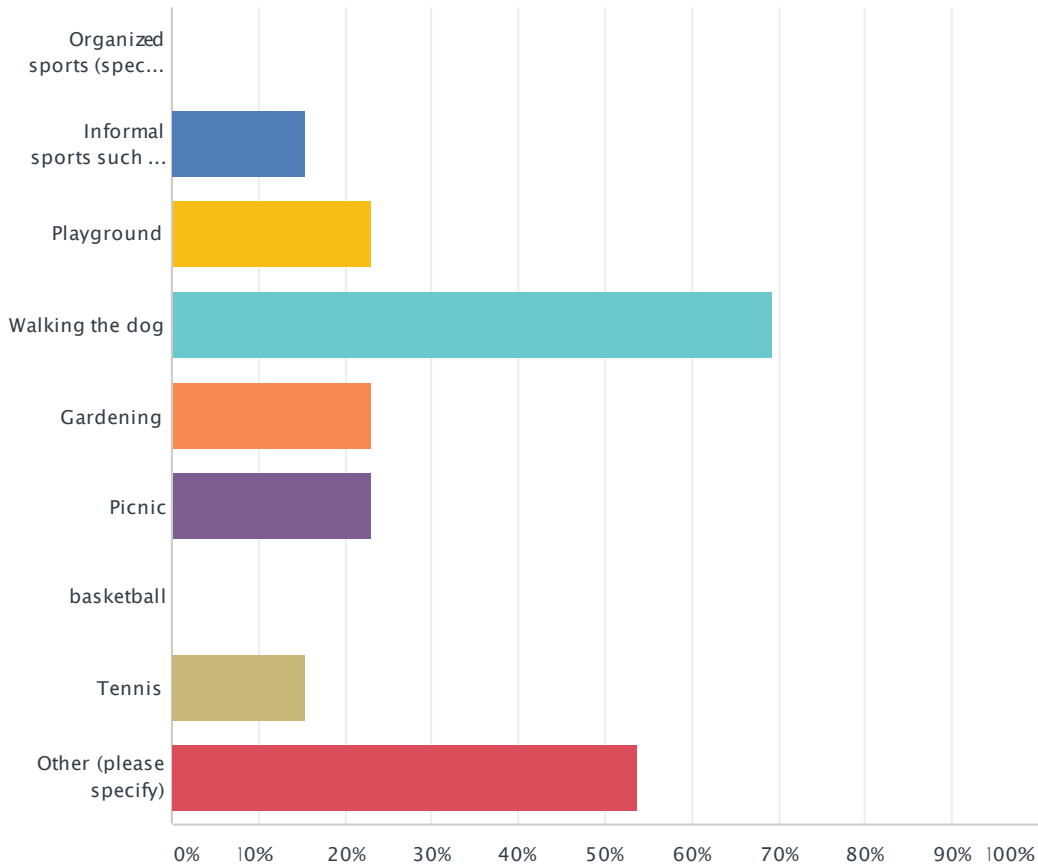

ANSWER CHOICES	RESPONSES	
Organized sports (specify below)	0.00%	0
Informal sports such as soccer (specify below)	15.38%	2
Playground	23.08%	3
Walking the dog	69.23%	9
Gardening	23.08%	3
Picnic	23.08%	3
basketball	0.00%	0
Tennis	15.38%	2
Other (please specify)	53.85%	7
Total Respondents: 13		

#	OTHER (PLEASE SPECIFY)	DATE
1	quiet and peaceful to relax and watch the blue birds and hummingbirds.	9/10/2015 11:09 AM
2	Frisbee Going to the creek Tossing a ball with friends	9/9/2015 10:00 PM

# Q7 What prevents you from visiting the park more often? (check all that apply)

Answered: 10 Skipped: 3

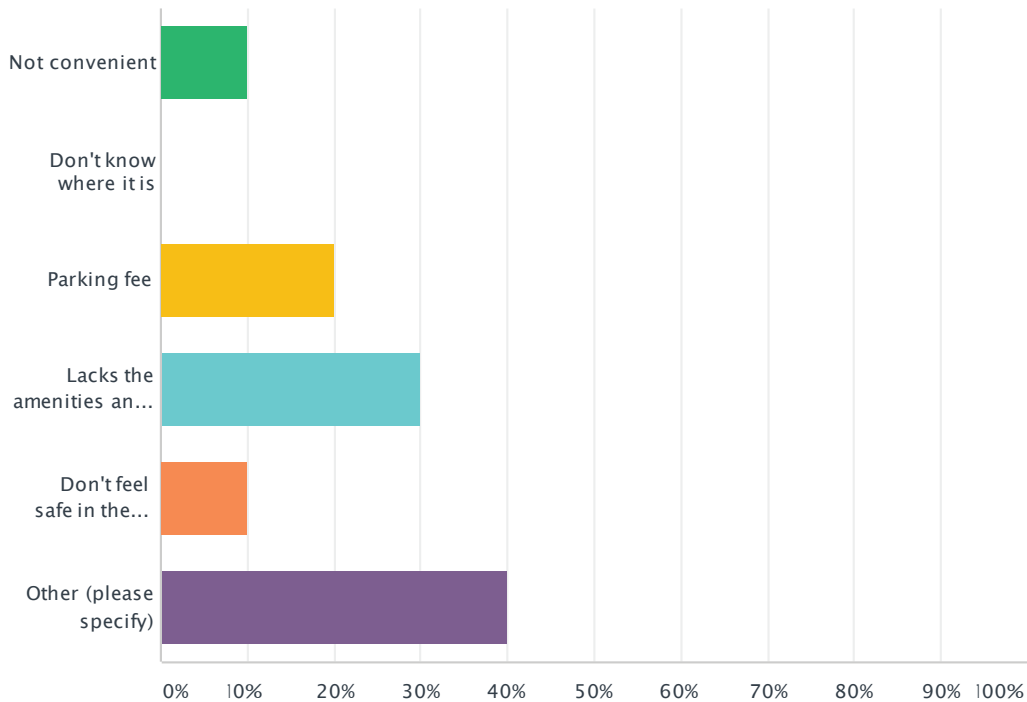

ANSWER CHOICES	RESPONSES	
Not convenient	10.00%	1
Don't know where it is	0.00%	0
Parking fee	20.00%	2
Lacks the amenities and facilities I desire	30.00%	3
Don't feel safe in the park	10.00%	1
Other (please specify)	40.00%	4
Total Respondents: 10		

#	OTHER (PLEASE SPECIFY)	DATE
1	Overrun with soccer matches on the Sunday's -and can't use the field that day. Minor minor issue.	9/9/2015 10:00 PM
2	Not me, but many people's concern is safety	9/6/2015 1:44 PM
3	Nothing	9/5/2015 3:37 PM
4	Run down	9/4/2015 1:50 PM



## Q8 If you don't feel safe in the park please tell us why?

Answered: 7 Skipped: 6

#	RESPONSES	DATE
1	There is not enough patrol, I live on De Chene Ave and I hear people at the park and smell people smoking pot	9/11/2015 7:24 PM
2	The park is safe. I have been there at all hours and on every day. The youth is respectful but a bit messy.	9/10/2015 11:09 AM
3	I have lived on the border of the park for 12 years and never felt threatened in the slightest. And I use the park almost daily.	9/9/2015 10:00 PM
4	I live adjacent to the park and always feel safe in the park. I don't want bright lights ruining my night sky viewing (Star Gazing) OR SLEEPING -- our windows face right into the park -- I even see the park ranger's car lights from my bedroom.	9/9/2015 4:59 PM
5	Bad reputation for drug-alcohol consumption especially by teens	9/6/2015 1:44 PM
6	I feel safe	9/5/2015 3:37 PM
7	Have witnessed drug deals, lots of trash	9/4/2015 1:50 PM

# Q9 What other park and recreation facilities do you use in the area? (choose your top three)

Answered: 13 Skipped: 0

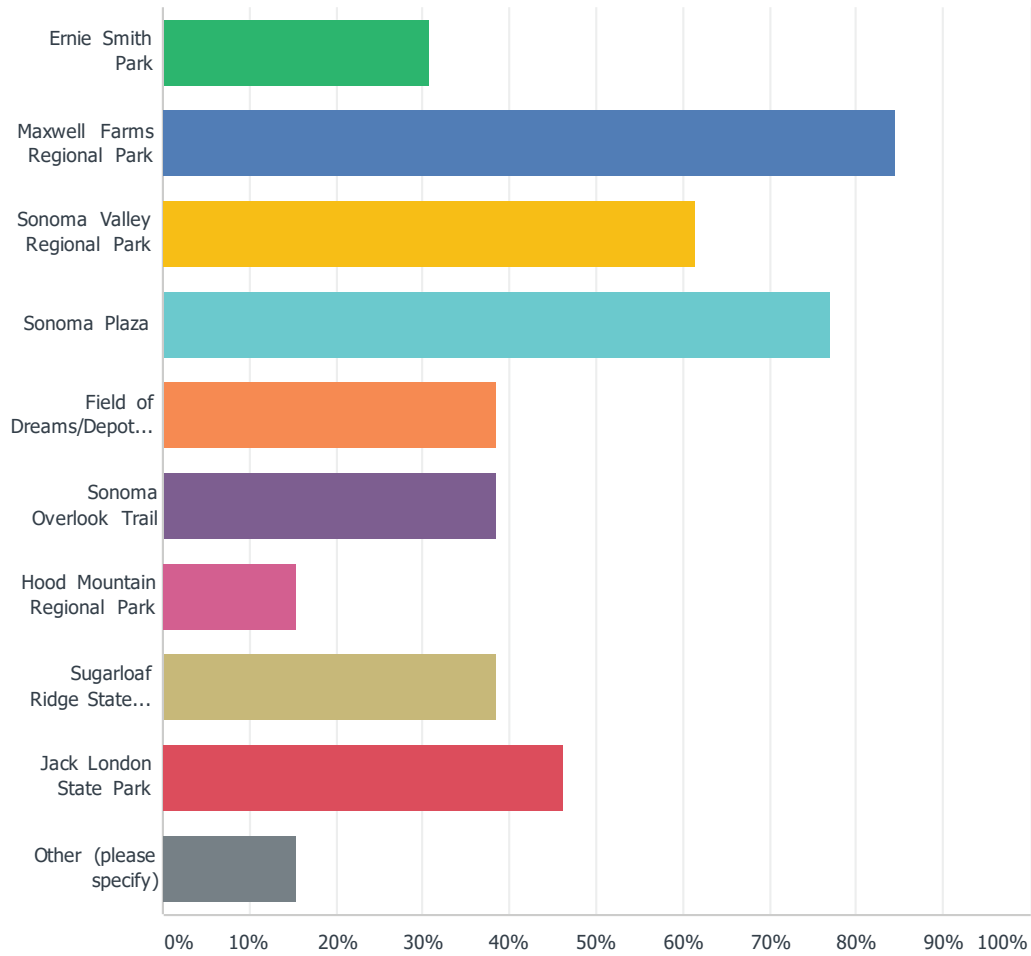

ANSWER CHOICES	RESPONSES	
Ernie Smith Park	30.77%	4
Maxwell Farms Regional Park	84.62%	11
Sonoma Valley Regional Park	61.54%	8
Sonoma Plaza	76.92%	10
Field of Dreams/Depot Park/Arnold Field	38.46%	5
Sonoma Overlook Trail	38.46%	5
Hood Mountain Regional Park	15.38%	2
SugarloafRidge State Park	38.46%	5
Jack London State Park	46.15%	6
Other (please specify)	15.38%	2

# Q10 What new amenities, facilities, activities, and/or programs would you be in favor of developing at the park. (please specify)

Answered: 11 Skipped: 2

#	RESPONSES	DATE
1	Expanded community garden area.	9/13/2015 9:11 AM
2	Hiking trails, real bathrooms. If there is anything else developed, there needs to be something done about the traffic and people speeding on De Chene. The people who play soccer on the field on Sunday speed now and it is very dangerous	9/11/2015 7:24 PM
3	Need no smoking signs. Need no fishing signs since wildlife should be protected. Need more pick-up your trash signs since people are pigs.	9/10/2015 11:09 AM
4	None	9/9/2015 11:19 PM
5	Upgrading the kids playground so its of the same quality as maxwells. My daughter NEVER wants to play on the structure at Larsons but loves maxwells. Upgrade / expand the picnic area by the creek. Open the bathrooms or install bathrooms.	9/9/2015 10:00 PM
6	Swings for little kids. Slash park for kids to play in. Playground with ramps for kids with special needs.	9/9/2015 5:30 PM
7	Upgrading the kids playground - its woefully sad and small compared to say Maxwell Farms. It would be great for local families to have a nicer kids playground. Encouraging kids and families to visit the park and not just teenage boys and older men...(and you can read anything you want into that!) There is a nice softball field that is not being used and could be turned in to nice expanded play area or -- more community gardens. Anything that promotes FAMILIES and GARDENS and KIDS. (as opposed to adult male soccer) Also you need bath room facilities! The soccer games bring lots of families cheering (super!) but no where to for them to use a bathroom except the fence lines of peoples houses. It can get smelly some weekends. And the litter is a lot after a game. More garbage cans are needed.	9/9/2015 4:59 PM
8	barbeque area, better basketball hoops/courts	9/7/2015 9:24 PM
9	nice picnic area, keep community garden, keep up the baseball diamond, hae good lighting and lawn areas.	9/6/2015 1:44 PM
10	A well-lighted, lockable bathroom rather than port-a-potty The completed bike path bridge Safer access to the creek Improved basketball hoops, soccer field and water fountain (maybe more water fountains) Walled "indoor" soccer court	9/5/2015 3:37 PM
11	Better landscaping and use of the creeks as an amenity. Link the park with a bike path. Water features for kids?	9/4/2015 1:50 PM

## Q11 Please describe any specific amenities, facilities, activities, and/or programs that you would NOT like to see developed at the park.

Answered: 8 Skipped: 5

#	RESPONSES	DATE
1	No ball fields of any kind. No, or less, lawns.	9/13/2015 9:11 AM
2	Anything that causes a lot more traffic on my street	9/11/2015 7:24 PM
3	No more parking. To many cars as it is.	9/10/2015 11:09 AM
4	Anything	9/9/2015 11:19 PM
5	Opposed to lights and would prefer to see the park closed at dusk. Opposed to expanding soccer games as we are frazzled already by the increases of soccer that almost daily games and practices which restricts our use of the field for fun. And the soccer is a burden on our fence and men climbing into our yard for balls.	9/9/2015 10:00 PM
6	MORE Soccer games than we already have...there is already a LOT of soccer and the soccer players continue to climb over our fence to retrieve balls if we don't throw them back IMMEDIATELY. Ruins the privacy of our backyard. We don't mind throwing back the soccer balls or having a soccer ball return -- but having strangemen in our yard with our kids walking around is not OK. Plus it damages the fence and spooks us.	9/9/2015 4:59 PM
7	I am not sure. Keep the focus on safe, fun, family activities.	9/6/2015 1:44 PM
8	No more parking No bright lights except in very key areas (e.g., bathroom), none near the soccer field (that is where I go to stargaze) or where they will impact local residents	9/5/2015 3:37 PM

## Q12 Are there any existing amenities, facilities, activities, and/or programs that you would like to see removed or discontinued?

Answered: 8 Skipped: 5

#	RESPONSES	DATE
1	No, I enjoy the park now	9/11/2015 7:24 PM
2	Speaking as a gardener, and as a former Nuestra Voz Board Member, I must say that the community garden is under used and is not living up to the community garden it was developed as. New over-sight is needed and a managing partner needs to be selected.	9/10/2015 11:09 AM
3	Remove tennis courts and expand community growing gardens.	9/9/2015 11:19 PM
4	Less soccer but no need to be removed. Less soccer is preferred so we have some afternoons and one weekend where it's quiet and we can play in the field and run etc. Not trying to eliminate it entirely.	9/9/2015 10:00 PM
5	LESS SOCCER but not to eliminate it. There is suddenly a LOT more soccer games this year than in the past 10 years. you've passed a tipping point for us homeowners ...	9/9/2015 4:59 PM
6	Not sure. I want to find out more from the Parks to see what could be done.	9/6/2015 1:44 PM
7	Replace the tennis courts (or one of the courts) with a walled "indoor" soccer court. The tennis practice wall is mostly used for pick up games of walled soccer. It would be nice to have a real court so the players don't loose their ball all the time. Remove the old bridge once the new one is done, it is unsightly	9/5/2015 3:37 PM
8	Tennis courts need updating, there may not need to be so many	9/4/2015 1:50 PM

# Q13 Please provide any additional thoughts or issues that you feel should be considered or addressed during the re-visioning process for the park.

Answered: 7 Skipped: 6

#	RESPONSES	DATE
1	I love Larson park and believe it is a gem. If it is developed, it needs to be done so that the neighbors are happy	9/11/2015 7:24 PM
2	Would like to see the tennis courts maintained so there is another good place to play.	9/9/2015 11:17 PM
3	We have an intractable problem of men climbing in to our yard for their soccer balls -- if we don't toss it back immediately. Make the park more kid and family friendly. Would love to see young kids playing in the park.	9/9/2015 10:00 PM
4	Lighting. Keep the garden. Keep a nice place for littlekids to enjoy.	9/9/2015 5:30 PM
5	I absolutely don't want bright lights at night added to the park. This would ruin night sky viewing (Star Gazing) and add to the light pollution. It would also encourage NIGHT TIME activity which is NOT ok. The park should be closed after dark - and remain in the dark too. SLEEPING -- our windows face right in to the park -- I even see the park ranger's car lights from my bedroom.	9/9/2015 4:59 PM
6	I am sure that many ideas will surge from the public discussions - hopefully safety will be emphasized.	9/6/2015 1:44 PM
7	An electronic gate that gives the sheriffs the ability to drive into the park at night to keep a watch on it. It seems to me they do not like to get out of their cars and walk into the park at night even if there has been a disturbance.	9/5/2015 3:37 PM

## Appendix D. Preliminary Estimate of cost

Sonoma County Regional Parks					
Larson Park - Preliminary Opinion of Cost					
Civil On Site					
Item No	Description	Unit	Quantity	Unit Cost	Item Total
1	Construction Staking and Layout	1	EA	LS	\$10,000
2	Grading, Clearing and Grubbing	1	EA	LS	\$120,000
3	Sewer Hook Up	1	EA	LS	\$10,000
4	Electrical Service	1	EA	LS	\$20,000
5	Water Connection	1	EA	LS	\$20,000
6	Site Drainage	1	EA	LS	\$100,000
Subtotal					\$280,000.00
Paving and Surfacing					
Item No	Description	Unit	Quantity	Unit Cost	Item Total
7	Concrete	SF	20,000	\$15.00	\$300,000
8	Asphalt	SF	7,000	\$8.00	\$56,000
8	Decomposed Granite	SF	4,500	\$7.50	\$33,750
9	Play Area Surfacing (wood fiber)	SF	6,000	\$6.50	\$39,000
Subtotal					\$428,750.00
Recreational Ammenities					
Item No	Description	Unit	Quantity	Unit Cost	Item Total
10	Ball Field (includes irrigation)	SF	38,347	\$10.50	\$402,644
11	Soccer Field w/ Natural Turf (includes irrigation)	SF	66,675	\$6.50	\$433,388
12	Tennis (3 total) and Pickleball Courts (4)	EA	1	LS	\$125,000
14	Small Covered Picnic Area	EA	1	LS	\$25,000
15	Group Picnic Area w/ Grill	EA	1	LS	\$20,000
16	Shade Structure	EA	1	LS	\$20,000
17	Restroom	EA	1	LS	\$132,000
18	Full Court Basketball Court	EA	1	LS	\$40,000
19	Ball Wall	LS	2	LS	\$10,000
20	Play Area (Ages 5-12 and Ages 3-5) w/ Equipment	EA	1	LS	\$91,000
21	Community Garden Upgrades	EA	1	LS	\$10,000
Subtotal					\$1,309,031.00

Landscape Irrigation and Planting					
Item No	Description	Unit	Quantity	Unit Cost	Item Total
30	Landscape Irrigation	EA	1	LS	\$70,000
31	Trees (24" Box)	EA	19	\$500	\$9,500
32	Plants (5 Gallon)	EA	100	\$50	\$5,000
33	Plants (1 Gallon)	EA	200	\$25	\$5,000
34	Landscape Mulch	SF	2683	\$2	\$5,366
Subtotal					\$94,866.00
Vegetation Management Along Sonoma Creek and El Pequeño Creek					
Item No	Description	Unit	Quantity	Unit Cost	Item Total
35	Weed Removal	EA	1	LS	\$10,000
36	Revegetation	EA	1	LS	\$50,000
37	Temporary Irrigation	EA	1	LS	\$20,000
Subtotal					\$80,000.00
Improvements Total					\$2,300,472
Contingency (15%)					\$345,070.80
Overhead Profit and Insurance and Bonding (10%)					\$230,047.20
General Conditions (5%)					\$115,023.60
Permits (1.5%)					\$34,507.08
Projected Construction Bid Total					\$3,025,121

# Appendix E. Existing site conditions photos





